



GSIS Government Service Insurance System
Financial Center, Pasay City, Metro Manila 1308

**GSIS BIDS AND AWARDS COMMITTEE
FOR INFRASTRUCTURE AND INFORMATION TECHNOLOGY**

Project Title: Rehabilitation of Parking Areas at the GSIS Central Office Building

**Bid Bulletin No. 1
03 January 2020**

This bid bulletin is issued to provide the Plans/Drawings and Bill of Quantities for the project *Rehabilitation of Parking Areas at the GSIS Central Office Building*. This shall form an integral part of the Bidding Documents.

1. Section VII. Plans/Drawings

- No. of Pages: 4

2. Section VIII. Bill of Quantities

- Number of Pages: 6

For the guidance and information of all concerned.

SVP RACQUEL DE GUZMAN - BUENSALIDA
Chairperson
GBAC for Infrastructure and Information Technology

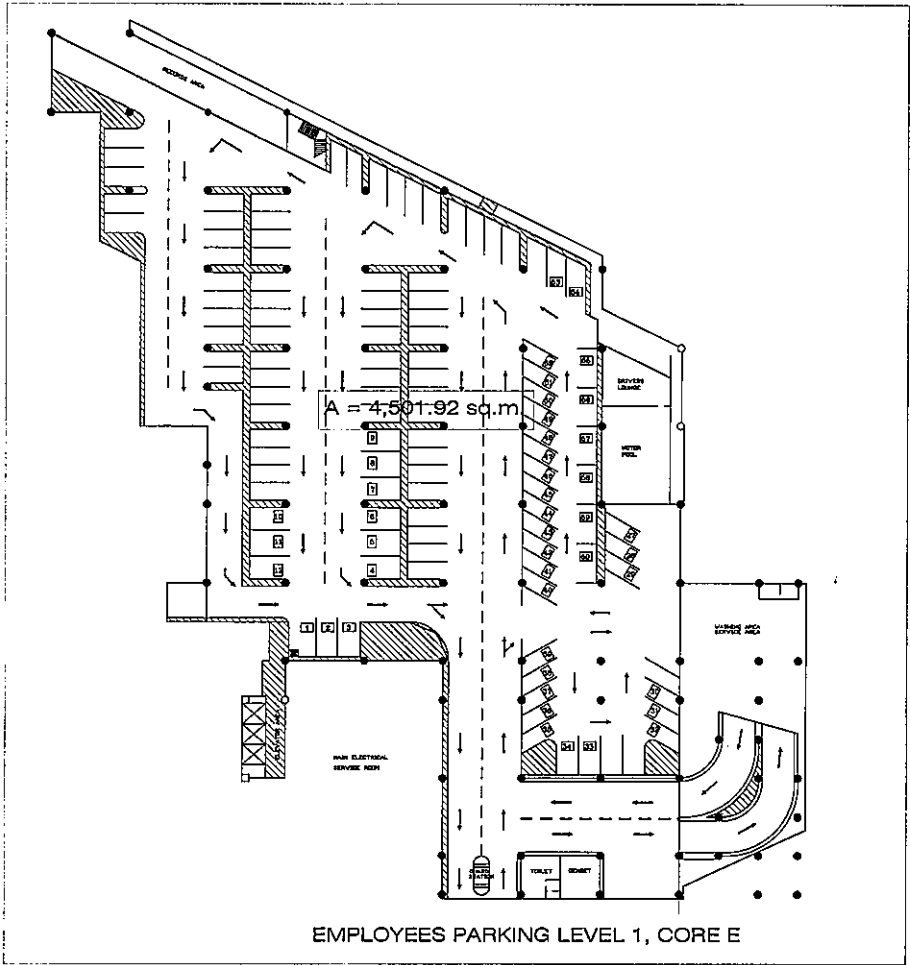

A = 4,501.92 sq.m

EMPLOYEES PARKING LEVEL 1, CORE E

Handwritten signature and initials

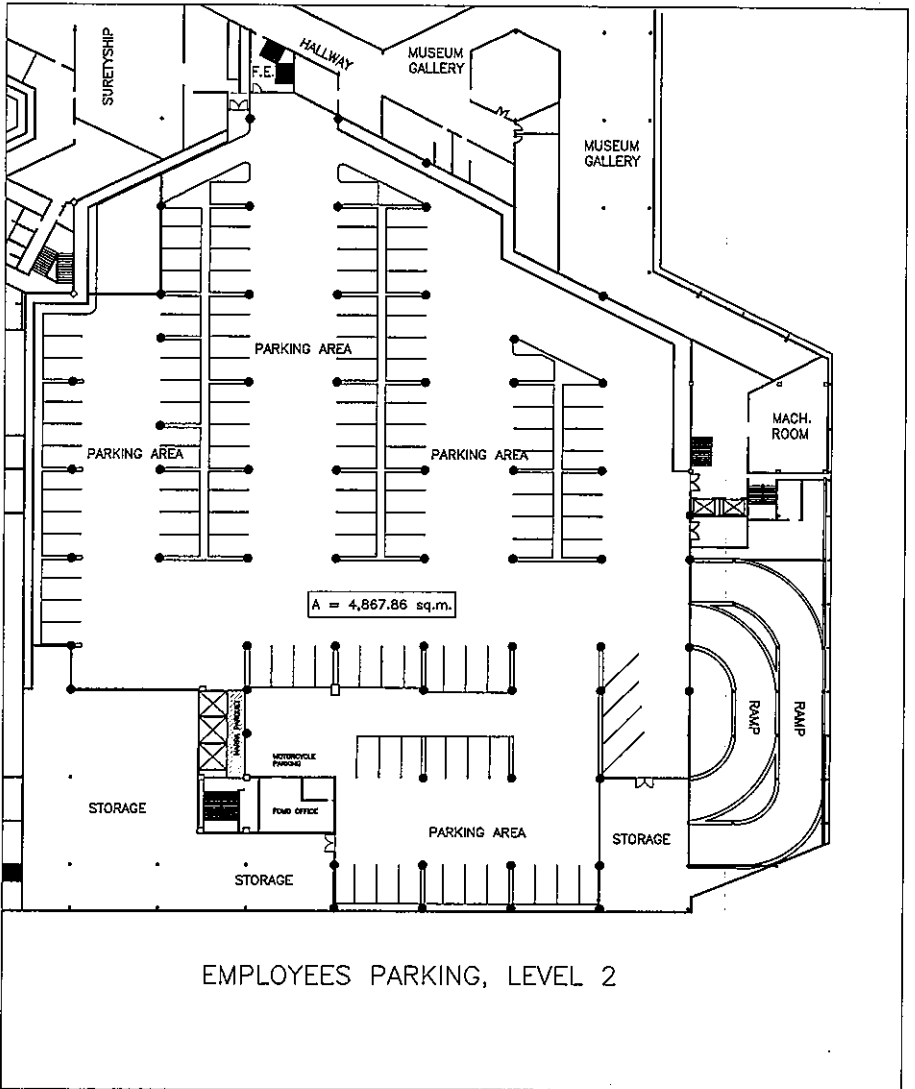

EMPLOYEES PARKING, LEVEL 2

Handwritten signature or initials.

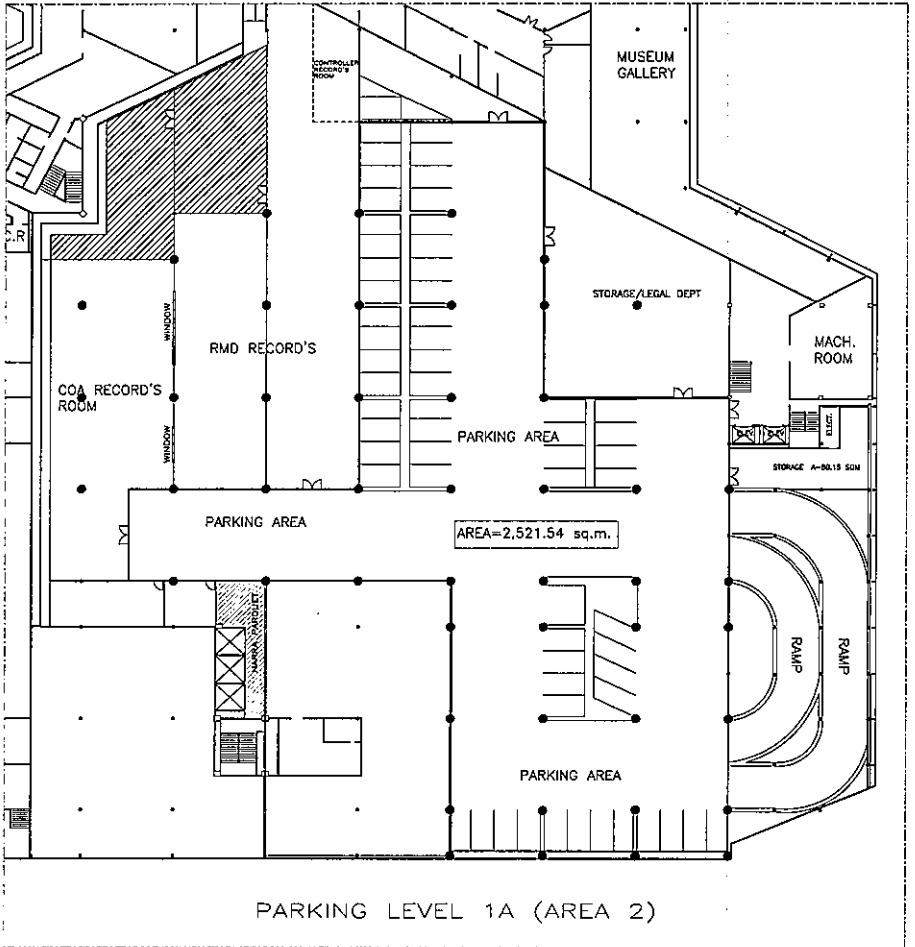

Handwritten signature/initials

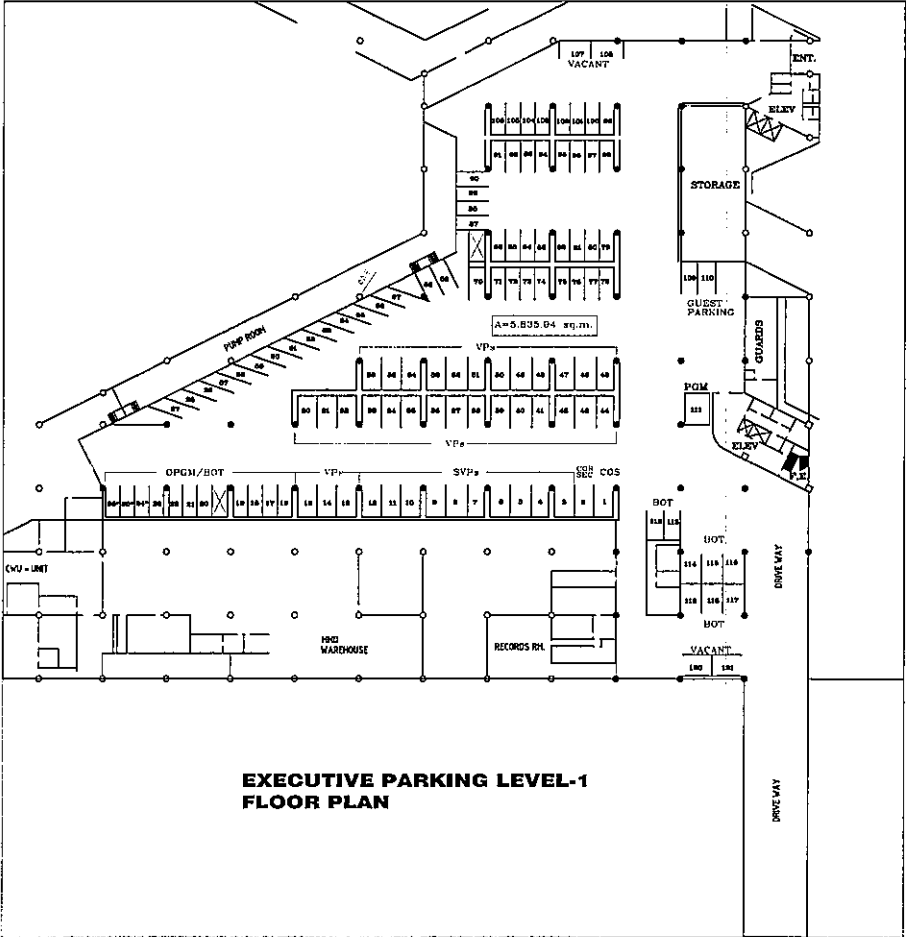

f. y. r.

PROJECT: RENOVATION OF PARKING AREAS AT THE GSS CENTRAL OFFICE BUILDING
 LOCATION: GSS Financial Center, Psey City
 ITEMIZED BID COST / BILL OF QUANTITIES

ITEM NO.	DESCRIPTION	QTY	UNIT	UNIT COST	MATERIALS COST	LABOR	ESTIMATED DIRECT COST	MARK-UPS IN PERCENT	TOTAL MARK-UP	VAT	TOTAL INDIRECT COST	TOTAL €
1.0	GENERAL REQUIREMENTS											
	1.1 Mobilization / Demobilization	1.00	lot									
	1.2 Safety and Health Program											
2.0	SURFACE PREPARATION OF CONCRETE FLOORINGS	17,260.00	sq m									
	2.1 Executive Parking, Level 1 Core C, including	5,840.00	sq m									
	2.2 Employees Parking, Level 1 Core E	4,505.00	sq m									
	2.3 Employees Parking, Level 2 Core E	4,870.00	sq m									
	2.4 Employees Parking, Level 1A, Core E	2,525.00	sq m									
3.0	APPLICATION OF EPOXY PAINT FOR CONCRETE											
	3.1 Executive Parking, Level 1 Core C, including	5,840.00	sq m									
	3.1.1 Epoxy Enamel Paint, (Royal Blue with Curing Agent) two (2) coats	165.00	galis									
	3.1.3 Epoxy Primer, (Gray with Curing Agent) two (2) coats	150.00	galis									
	3.1.4 Paint Reducer	75.00	galis									
	3.1.5 Rubberized paint for marking lines and borders.	75.00	galis									
	3.2 Employees Parking, Level 1 Core E	4,505.00	sq m									
	3.2.1 Epoxy Enamel Paint, (Royal Blue with Curing Agent) two (2) coats	130.00	galis									
	3.2.2 Epoxy Primer, (Gray with Curing Agent) two (2) coats	100.00	galis									
	3.2.3 Paint Reducer	50.00	galis									
	3.2.4 Rubberized paint for marking lines and borders.	50.00	galis									
	3.3 Employees Parking, Level 2 Core E	4,870.00	sq m									
	3.3.1 Epoxy Enamel Paint, (Royal Blue with Curing Agent) two (2) coats	140.00	galis									
	3.3.2 Epoxy Primer, (Gray with Curing Agent) two (2) coats	100.00	galis									
	3.3.3 Paint Reducer	50.00	galis									
	3.3.4 Rubberized paint for marking lines and borders.	50.00	galis									
	3.4 Employees Parking, Level 1A, Core E	2,525.00	sq m									

ITEM NO.	DESCRIPTION	QTY	UNIT	UNIT COST	MATERIALS COST	LABOR	ESTIMATED DIRECT COST	MARK-UPS IN PERCENT	TOTAL MARK-UP VALUE	VAT	TOTAL INDIRECT COST	TOTAL COST
(1)	(2)	(3)	(4)	(5)	(6)	(7)	(8)	(9)	(10)	(11)	(12)	(13)
								DCM	PROFIT	%	(9) + (10)	(9) + (11)
												(5) + (12)
6.1.4	Masonry Putty	75.00	pails									
6.1.5	Sanding Paper #120	75.00	dozen									
6.1.6	Assorted Sise Paint brush	30.00	PCS									
6.1.7	Roller brush #9 w/ tray	30.00	PCS									
6.1.8	Metal Hanger rod	1.00	lot									
6.2	Employees Parking, Level 1, Core E	6,760.00	sq. m									
6.2.1	Permacoat Semi-Gloss Latex Paint white, (2 coats)	140.00	pails									
6.2.2	Quick Drying Enamel Paint	25.00	pails									
6.2.3	Paint Thinner	15.00	gals									
6.2.4	Masonry Putty	50.00	pails									
6.2.5	Sanding Paper #120	40.00	dozen									
6.2.6	Assorted Sise Paint brush	25.00	PCS									
6.2.7	Roller brush #9 w/ tray	25.00	PCS									
6.2.8	Metal Hanger rod	1.00	lot									
6.3	Employees Parking, Level 2, Core E	7,305.00	sq. m									
6.3.1	Permacoat Semi-Gloss Latex Paint white, (2 coats)	150.00	pails									
6.3.2	Quick Drying Enamel Paint	25.00	pails									
6.3.3	Paint Thinner	15.00	gals									
6.3.4	Masonry Putty	60.00	pails									
6.3.5	Sanding Paper #120	50.00	dozen									
6.3.6	Assorted Sise Paint brush	25.00	PCS									
6.3.7	Roller brush #9 w/ tray	25.00	PCS									
6.3.8	Metal Hanger rod	1.00	lot									
6.4	Employees Parking, Level 1A, Core E	3,788.00	sq. m									
6.4.1	Permacoat Semi-Gloss Latex Paint white, (2 coats)	80.00	pails									
6.4.2	Quick Drying Enamel Paint	25.00	pails									
6.4.3	Paint Thinner	15.00	gals									
6.4.4	Masonry Putty	50.00	pails									
6.4.5	Sanding Paper #120	50.00	dozen									
6.4.6	Assorted Sise Paint brush	25.00	PCS									
6.4.7	Roller brush #9 w/ tray	25.00	PCS									
6.4.8	Metal Hanger rod	1.00	lot									
7.0	REFLECTORIZED PAINT, YELLOW & BLACK COLOR											
7.1	Executive Parking, Level 1, Core C, including	76.00	sq. m									
7.1.1	ReflectORIZED Traffic Paint, yellow	10.00	gals									
7.1.2	ReflectORIZED Traffic Paint, black	10.00	gals									
7.1.3	Paint Thinner	10.00	gals									
7.1.4	Paint Brush	10.00	PCS									

ITEM NO.	DESCRIPTION	QTY	UNIT MEASURE	UNIT COST	MATERIALS COST	LABOR	ESTIMATED DIRECT COST (3)	MARK-UPS IN PERCENT OCM (6)	PROFIT (7)	TOTAL MARK-UP VALUE (9)	VAT (10)	TOTAL INDIRECT COST (11)	TOTAL (12)
										(5) x (8)	5% (5) + (9)	(9) + (10)	(5) + (12)
9.0	Hauling and cleaning of debris and disposable materials outside the building premises.												
9.1	Executive Parking, Level 1, Core C	1.00	lot										
9.2	Employees Parking, Level 1, Core E	1.00	lot										
9.3	Employees Parking, Level 2, Core E	1.00	lot										
9.4	Employees Parking, Level 1A, Core E	1.00	lot										
TOTAL PROJECT COST													

Name of Contractor : _____

Complete Address : _____

Name of Authorized Representative and Signature : _____

Telephone No. : _____